

WEST VIRGINIA STRONG

The Comeback

A GUIDE TO OUTDOOR DINNING

May, 2020

Community Development Department

City of Ranson

312 S Mildred Street

Ranson, West Virginia 25438

(304) 725-1010

The Comeback

Executive Order

Under Gov. Justice's and Executive Order 2-20, and reopening plan West Virginia Strong — The Comeback, restaurants are now allowed to offer outdoor dining in addition to takeout and delivery. The State has published "Safely Opening our Restaurants Through Takeaway Service & Outdoor Dining" which provides operational guidance. The City of Ranson is providing this additional guidance for restaurants that do not currently have or would like to expand their outdoor dining opportunities to further advance our comeback.

As part of the Governor's reopen plan, the West Virginia Alcohol Beverage Control Administration ("ABCA") is developing a streamlined process with no fees for a restaurant to temporarily expand their floor space to include new or expanded outdoor dining space. Additional guidance on this process will be issued by the ABCA.

Open for Business

The City of Ranson is taking actions so that our business have every opportunity to prepared to be open for business as the Governor reopens our state. We want to assist our businesses as we all adapt the current challenges. The City would like to share innovative ideas that will support your business to open.

The City strongly supports the use of sidewalks for sidewalk cafes and outdoor dining throughout the City. Sidewalk cafes are temporary dining areas that occupy part of the public right of way, or the sidewalk, during the business hours of the adjacent host restaurant. Many of our businesses already provide outdoor dining, and others can quickly add outdoor dining with the ideas shared in this guidance.

The City has created this guidance to encourage our restaurants to open additional outdoor dining on sidewalks in the public right of way and within private property. Sidewalk cafes fill an immediate need to get our businesses open while enhancing public spaces and motivating city residents to patronize Ranson's eating establishments. Sidewalk cafés are different than outdoor dining, which are permanent spaces that are fixed into the ground, and provide a low risk investment for these businesses.

This guidance is intended to inspire low risk investments with the materials, tables and chairs, you may already have, and to maximize the public and private space adjacent to your business. We encourage you to contact the City's Community Development Department if you have questions, or if you are seeking additional ideas to expand your outdoor dining options.

Sidewalks

Sidewalk Cafe

Sidewalk cafés provide an opportunity for restaurants to expand onto the adjacent public sidewalk. The City’s wide sidewalks adjacent to commercial streets such as Fairfax Avenue and Mildred Street, can be utilized by these adjacent businesses to offer outdoor dining.

No permits are required to place tables and chairs on the sidewalk.

Tables are best placed adjacent to the building leaving a minimum of 5 feet of clear space on the sidewalk and into the building.

- Reserve 5 feet of clear sidewalk and access to the building
- Place tables and chairs adequately apart
- ABCA requirements for fencing may not be permitted on City Sidewalks

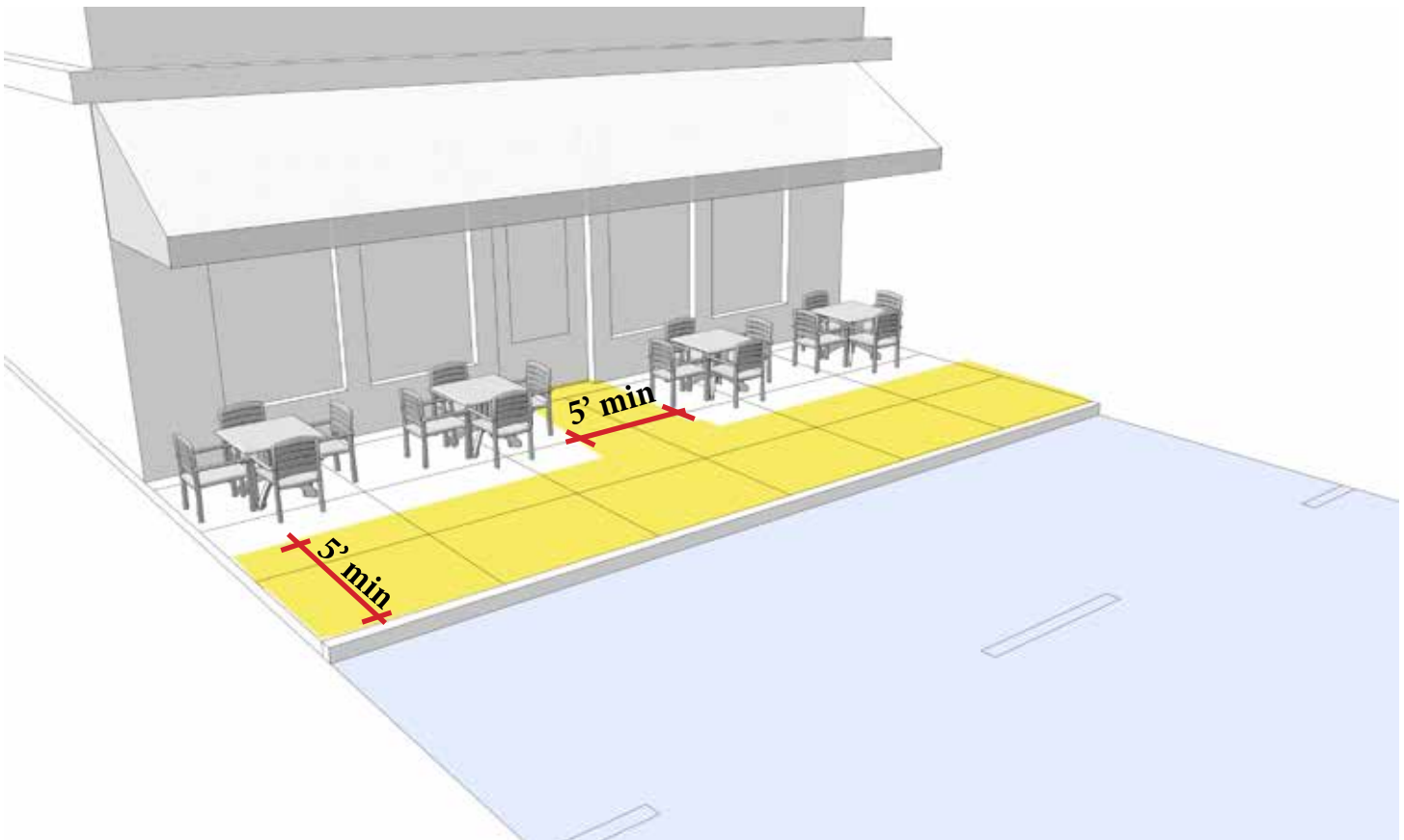
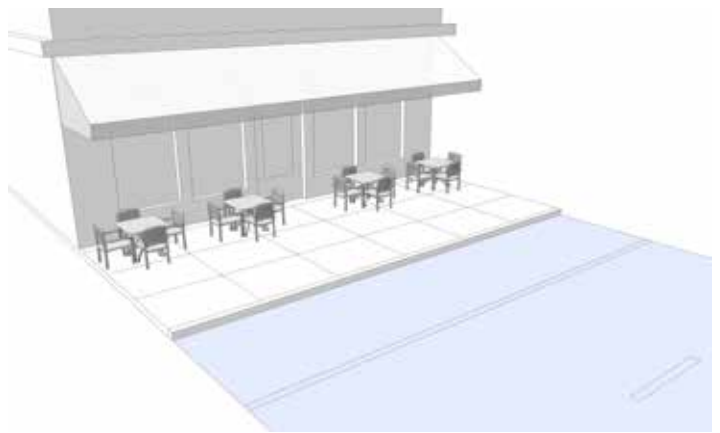

Parking Lots

Parking Area Conversions

Paved parking areas can easily be transformed into temporary outdoor dining areas without the need for permits from the City. The City's land development ordinances allow for reduced parking which provides an opportunity to transform parking areas into productive outdoor dining that are visible from the street.

Temporary fencing or barricades can be placed to keep the cars out. Temporary fencing that is under 4 feet and for this application shall not require a permit. Permanent fencing shall require a building permit.

Parking stalls near the front door of a restaurant, or near the restaurant's restrooms that are not accessible parking stalls are ideal for this conversion.

- Block out 2-3 parking stalls
- Use temporary fencing or barriers to keep the cars out
- Maintain a minimum of 5 feet clear space to the building entrance

